

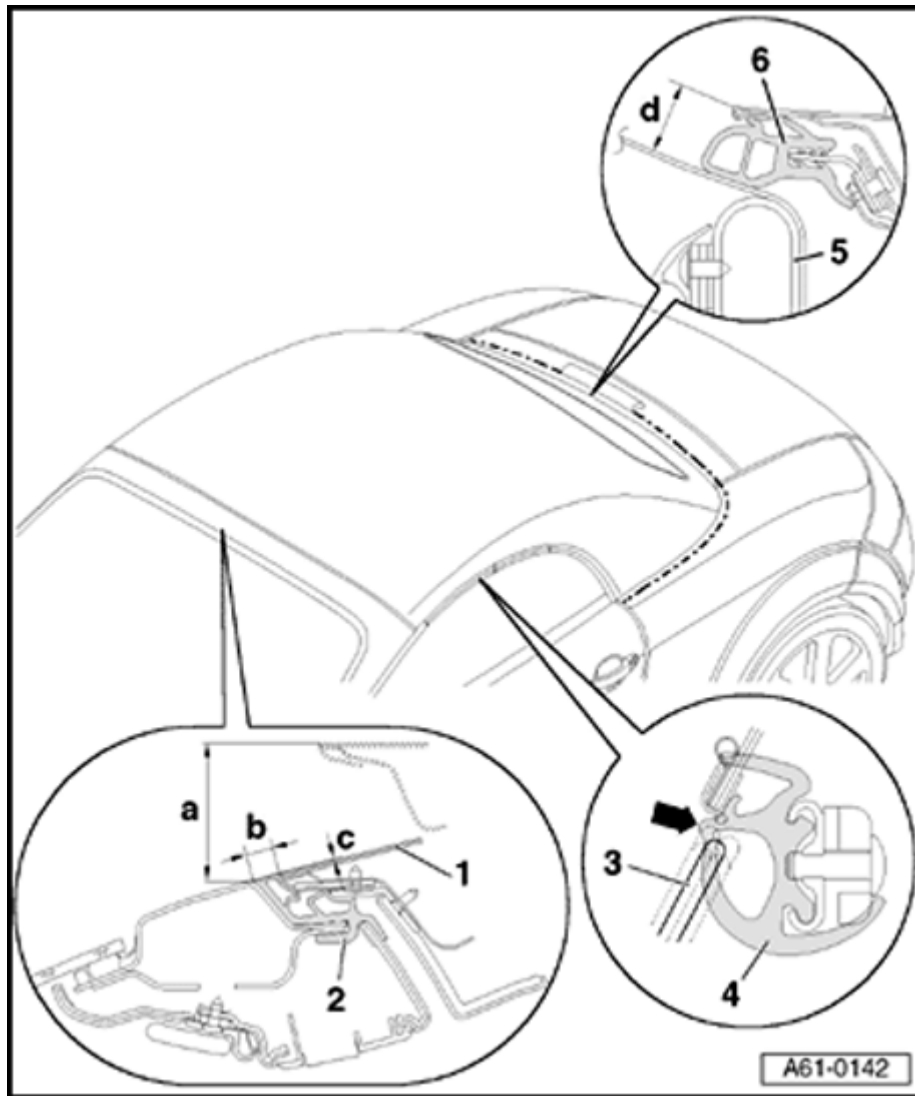

## Convertible top, installing

- Remove tensioning strut from main bearing.
- Lift convertible top over storage compartment and guide tensioning strut into storage compartment on one side.
- Place convertible top down in storage compartment diagonally toward front.
- Secure tensioning strut to main bearing and tighten bolts to 8 Nm.
- Insert convertible top and tighten hex bolts at main bearing to 20 Nm.
- Reattach trim for convertible top storage compartment at rear tensioning strut
- Reconnect electrical connections.
- Perform function test.
- Install various trim pieces.



## Convertible top, adjusting gaps and positioning dimensions

### 1 - Convertible top

- ◆ Dimension -a- = 35 mm ± 10 mm.
- ◆ This is the so-called "jump gap" for the convertible top.
- ◆ When the convertible top is opened, it must jump up approx. 35 mm.
- ◆ At this dimension, the forces required to close the convertible top are acceptable.
- ◆ Roof inset, dimension -c- = 1 mm ± 1 mm

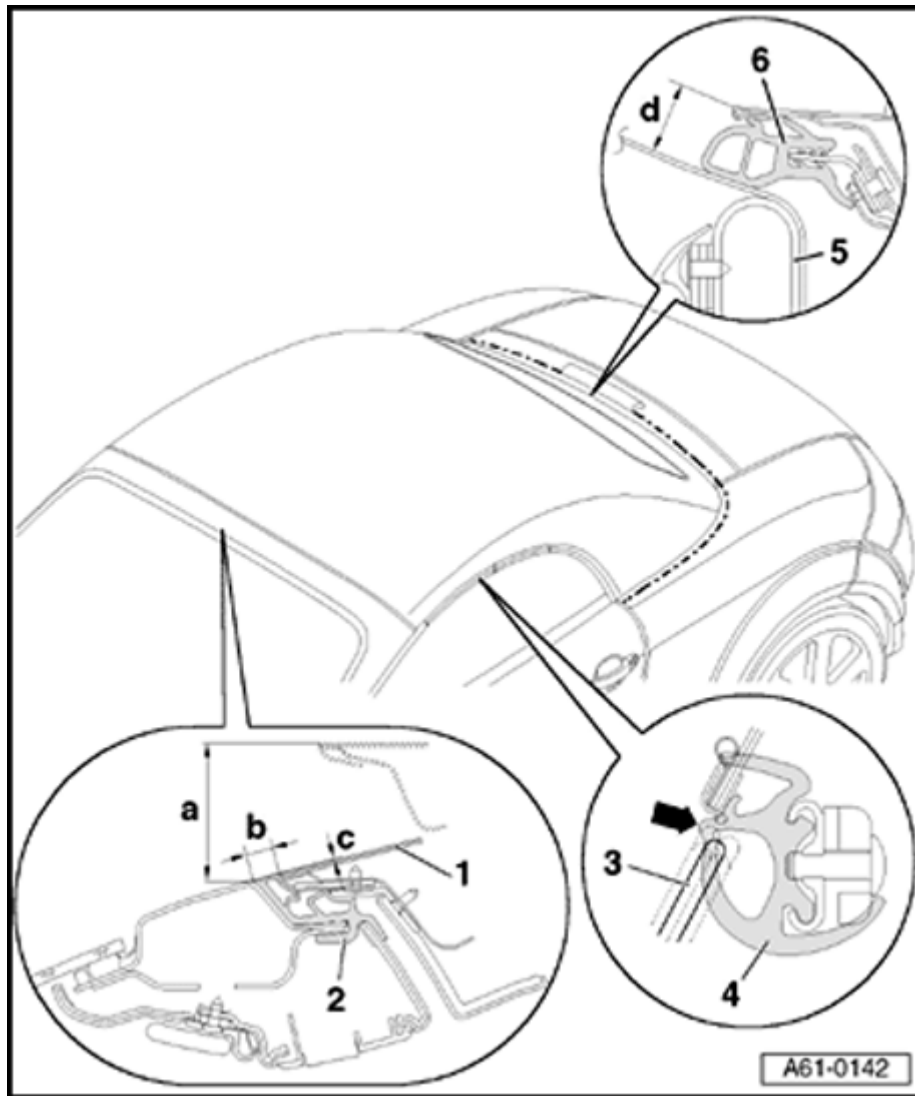

## 2 - Seal for front roof frame

- ♦ Dimension -b- = 9 mm + 2 mm.

## 3 - Window

- ♦ Window must only rise up to bulge (arrow) in seal -I-.

## 4 - Seal -I-

- ♦ Seals can be adjusted to specified positions from the side using shims.

## 5 - Tensioning strut

## 6 - Seal for tensioning strut

- ♦ Dimension -d- = 15 mm ± 2 mm



## Convertible top, adjusting

### Lengthwise

A

- First determine how far convertible top must be shifted at end plate -1-.
- Striker pin on convertible top must align with center of hole (arrow A).

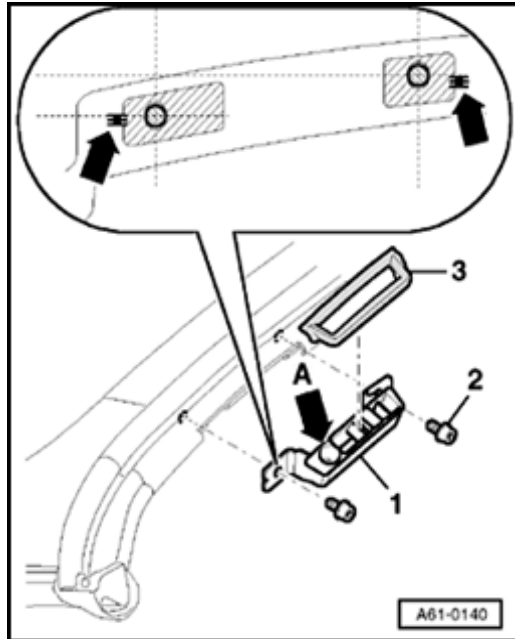

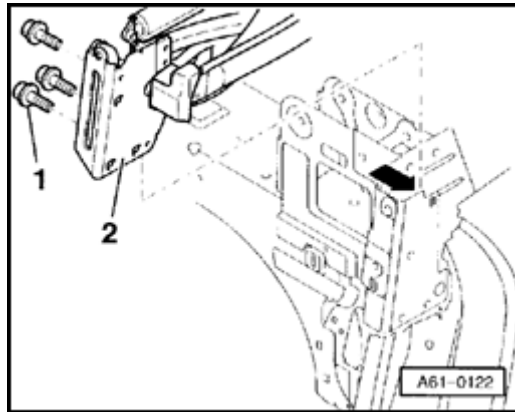

A

- To adjust convertible top lengthwise, loosen hex bolts -1- at left and right on main bearing -2-.

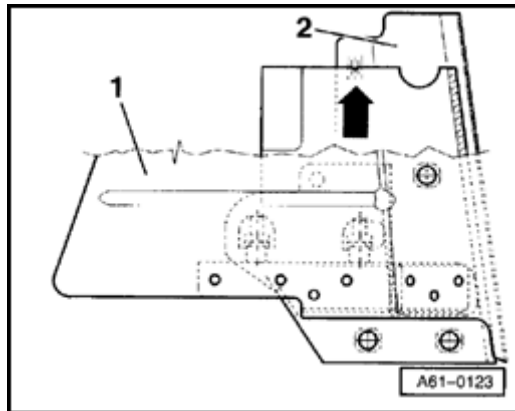

A

- Shift main bearing -1- of convertible top by the previously determined amount using markings (arrow) on chassis -2-.
- Striker pin on front of convertible top must align with center of hole on end plate.
- Tighten hex bolts on main bearing to 20 Nm.



## Height adjustment

- Remove roof frame trim

⇒ [Repair Manual , Body Interior, Repair Group 70, Roadster trim, roof frame trim, removing and installing.](#)

A

- To adjust height of convertible top at front, shift height of end plate.
- Markings (arrows) have been applied for more precise height adjustment.

