

Convertible top, servicing

Assembly overview

1 - Convertible top

- ♦ Removing ⇒ [page 61-4](#) .

2 - Hex bolt

- ♦ 20 Nm

3 - Main bearing

- ♦ There are gradations on the main bearing to facilitate adjustment ⇒ [page 61-15](#) .
- ♦ Before removing the convertible top, mark the position of the top relative to the gradations.
- ♦ Use these markings to adjust the main bearing during installation.
- ♦ Further adjustments are not necessary at that point.

4 - Stop

- ♦ Convertible top must be removed before removing/installing.

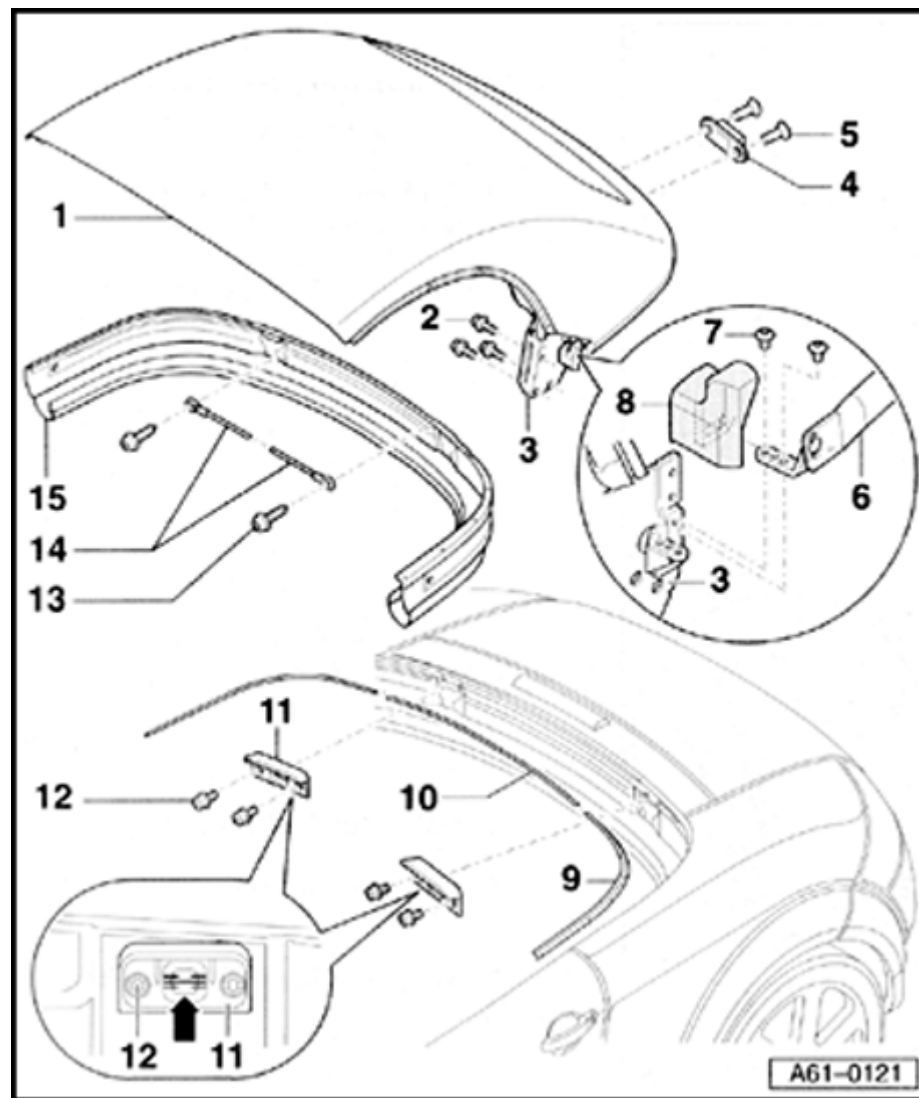

5 - Pop rivet

- ◆ Install using VAG 1753A pop rivet pliers

6 - Tensioning strut

- ◆ To remove, remove cover -8- and combination bolts -7-.
- ◆ Press bracket toward front and down at tensioning strut until tensioning strut is resting loosely in convertible top storage compartment.

7 - Combination bolt

- ◆ 8 Nm

8 - Cover for tensioning strut bearing

9 - Seal mount, left/right

10 - Seal mount, center

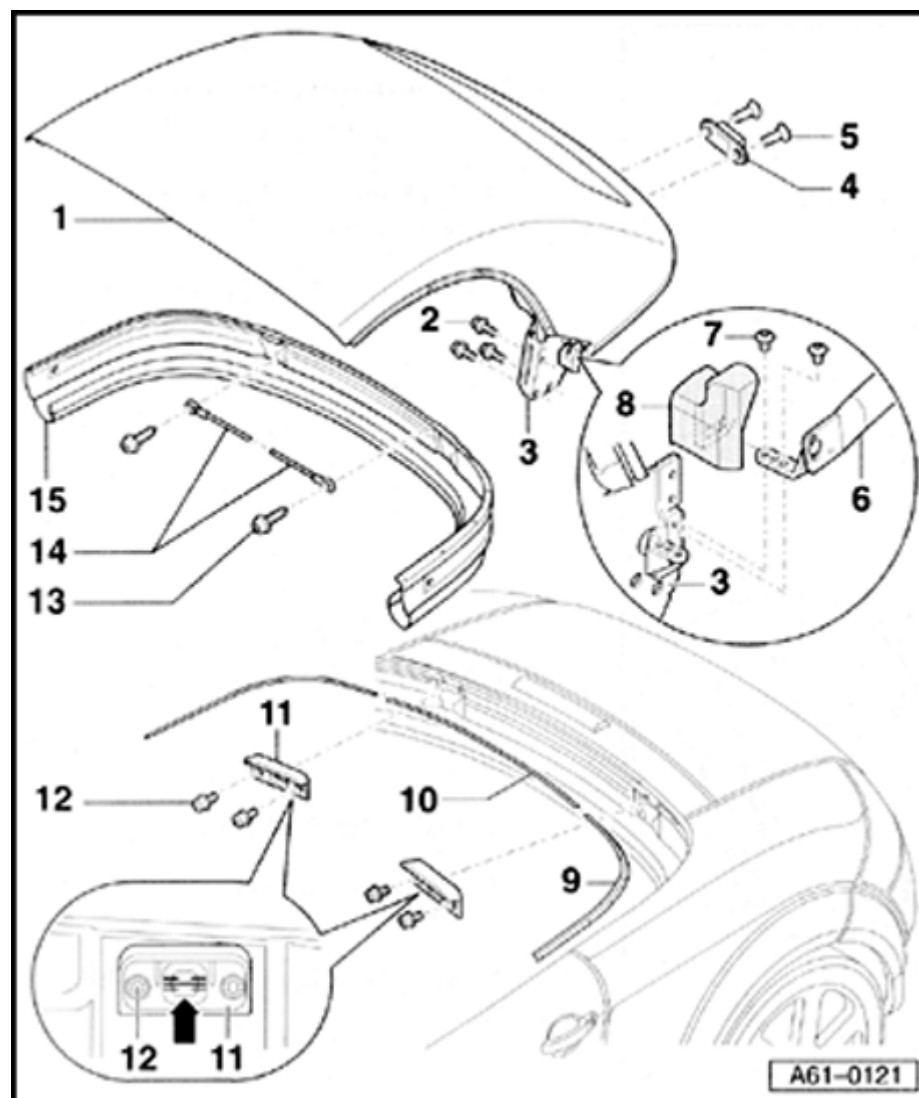

11 - Bracket

- ◆ There are markings on the bracket for height adjustment.
- ◆ Note position of markings before removal so that the same height can be set during installation.

12 - Torx bolt

- ◆ 15 Nm

13 - Torx bolt

- ◆ 4.5 Nm

14 - Tension strap

15 - Convertible top storage compartment trim

- ◆ Removing ⇒ [page 61-6](#)



Convertible top, removing

- Center trim for rear panel; remove side panel and rear panel cover.

⇒ [*Repair Manual , Body Interior, Repair Group 70, trim, Roadster.*](#)

Vehicles with manual convertible top operation

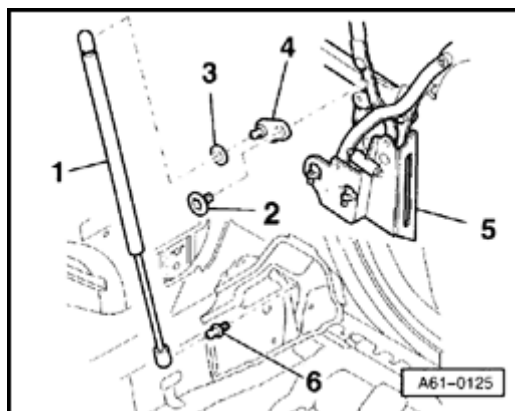

A

- With gas-filled strut -1- extended (top closed), disengage at the upper tab with ball studs -4- on left and right sides.
- Washer -3- must be pushed onto the tab with ball stud before attaching gas-filled strut.
- Main bearing -5- at convertible top.
- When installing tab with ball stud -4-, tighten bolt -2- to 6 Nm.
- Tighten ball stud -6- to 14 Nm when installing.



Vehicles with hydraulic convertible top operation

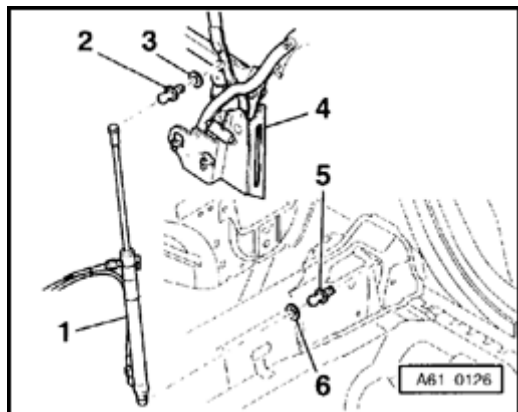

A

- Disengage hydraulic cylinder -1- at upper ball stud -2- with convertible top closed.
- Tighten ball studs -2- and -5- to 23 Nm when installing.
- Washer -3-.
- Main bearing -4- at convertible top.
- Rubber washer -6- must be pushed onto ball stud -5- before attaching hydraulic cylinder -1-.
- Disconnect electrical harness connectors for rear window defroster.
- Disengage trim for convertible top storage compartment at tensioning strut ⇒ [page 61-6](#) .

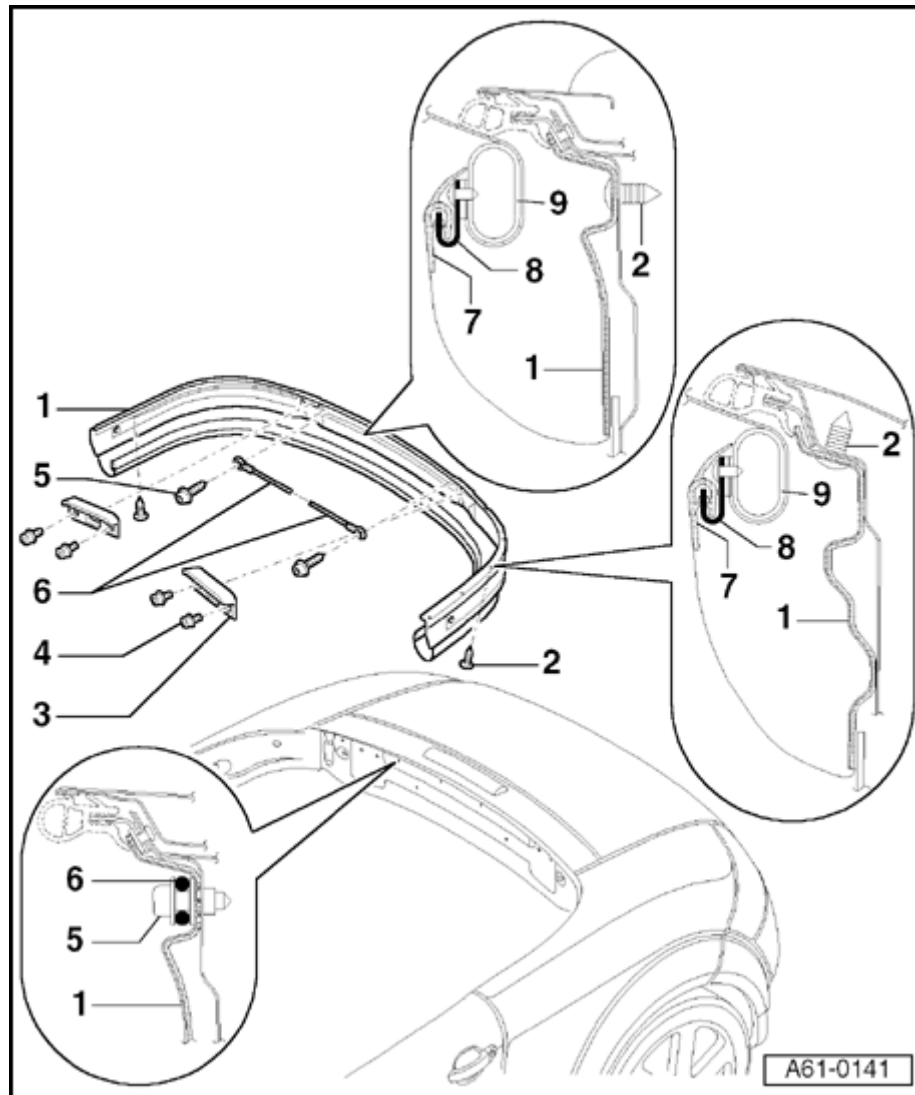

Convertible top storage compartment trim, removing and installing

1 - Convertible top storage compartment trim

- ◆ To remove convertible top, first disengage trim from retaining strip -8- at tensioning strut -9- (on interior side of vehicle).
- ◆ Convertible top must be removed before removing trim.
 - Remove bolts -4- and bracket -3-.
 - Unscrew Torx bolts -5- and remove tension strap -6-.
 - Remove clips -2- (14x) from trim.
 - Remove trim from convertible top storage compartment.

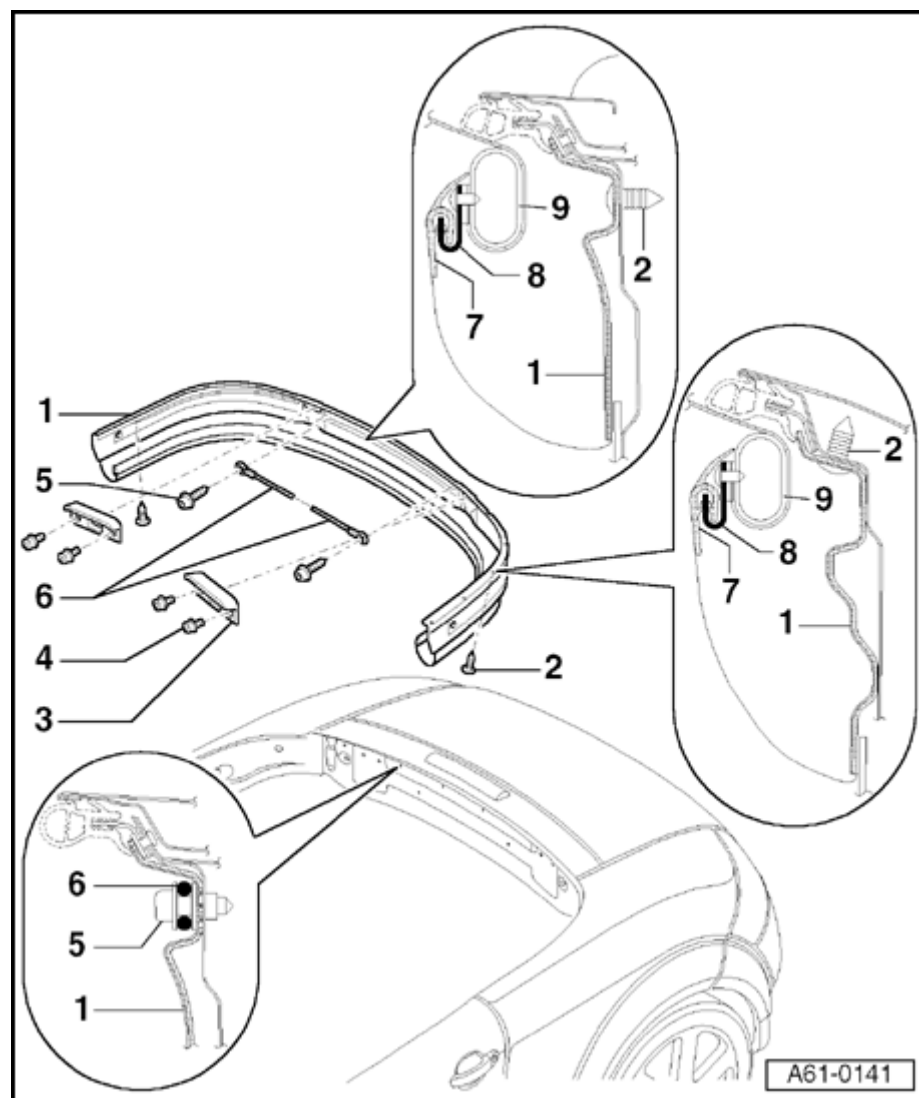
**2 - Clip**

- ◆ 14x

3 - Bracket

- ◆ There are markings on the bracket for height adjustment.
- ◆ Note position of markings before removal so that the same height can be set during installation.

4 - Torx bolt

- ◆ 15 Nm

5 - Torx bolt

- ◆ 4.5 Nm

6 - Tension strap**7 - Seal**

- ◆ Part of trim for convertible top storage compartment

8 - Retaining strip

- ◆ Two pieces, each bolted to tensioning strut (7x).

9 - Tensioning strut

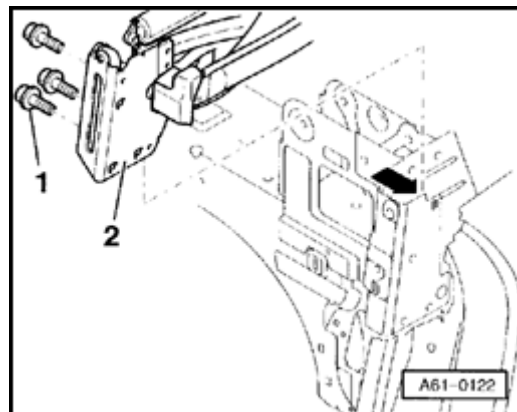

A

- Remove hex bolts -1- at left and right from main bearing.
- Push cover back slightly.
- Pull cover -2- from main bearing -1-.

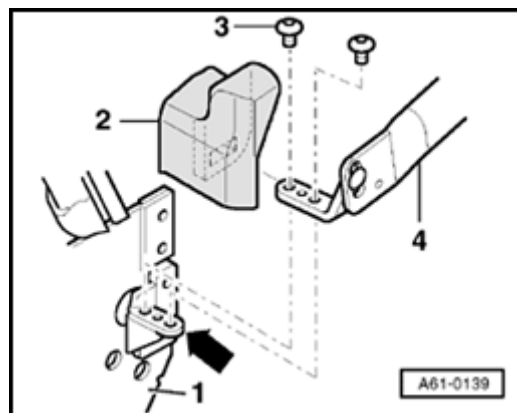

A

- Remove bolts -3- at left and right on tensioning strut -4-.
- Press tensioning strut toward front under bolting surface (arrow) at main bearing until tensioning strut is resting loosely in convertible top cover.



- Lift convertible top sufficiently at rear until tensioning strut can be lifted out.

A

- Take convertible top out of storage compartment and place on VAS 5219 assembly device.
- Secure tensioning strut at main bearing.

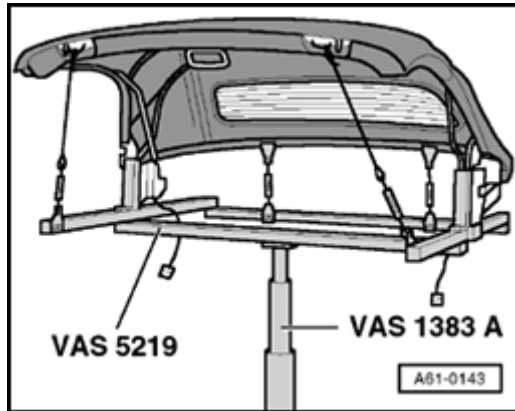

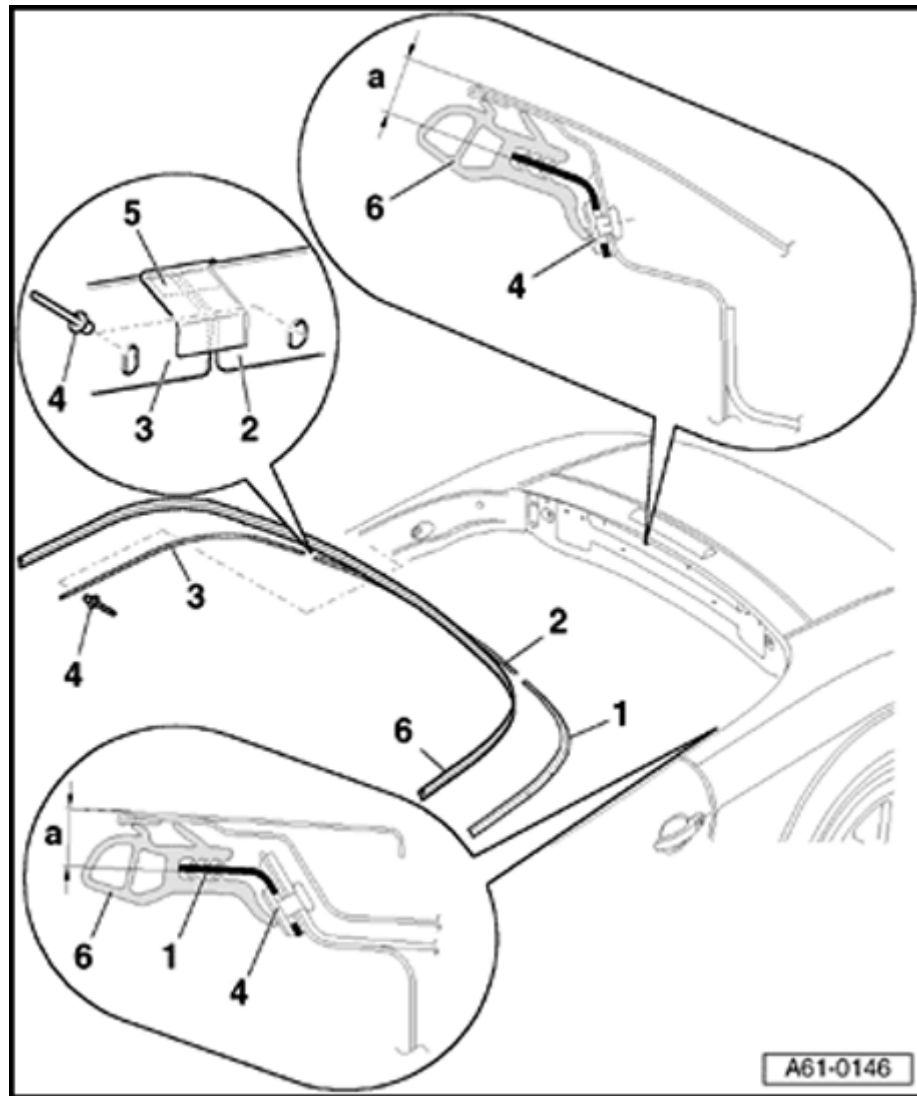

Tensioning strut seal and seal mount, removing and installing

1 - Seal mount, left

- ♦ Can only be removed or attached with convertible top removed.
- ♦ Install, left, center and right seal mounts
- ♦ Dimension -a- = 10 mm ± 0.5 mm as measured from lower lip of seal mount to upper edge of convertible top storage compartment.

2 - Seal mount, center

- ♦ Seal the abutting edges of seal mounts using AKD 512 000 05 sealant.
- ♦ Apply adhesive tape -5- to abutting edges from lower side before applying sealant.
- ♦ Dimension -a- = 10 mm ± 0.5 mm as measured from lower lip of seal mount to upper edge of convertible top storage compartment.

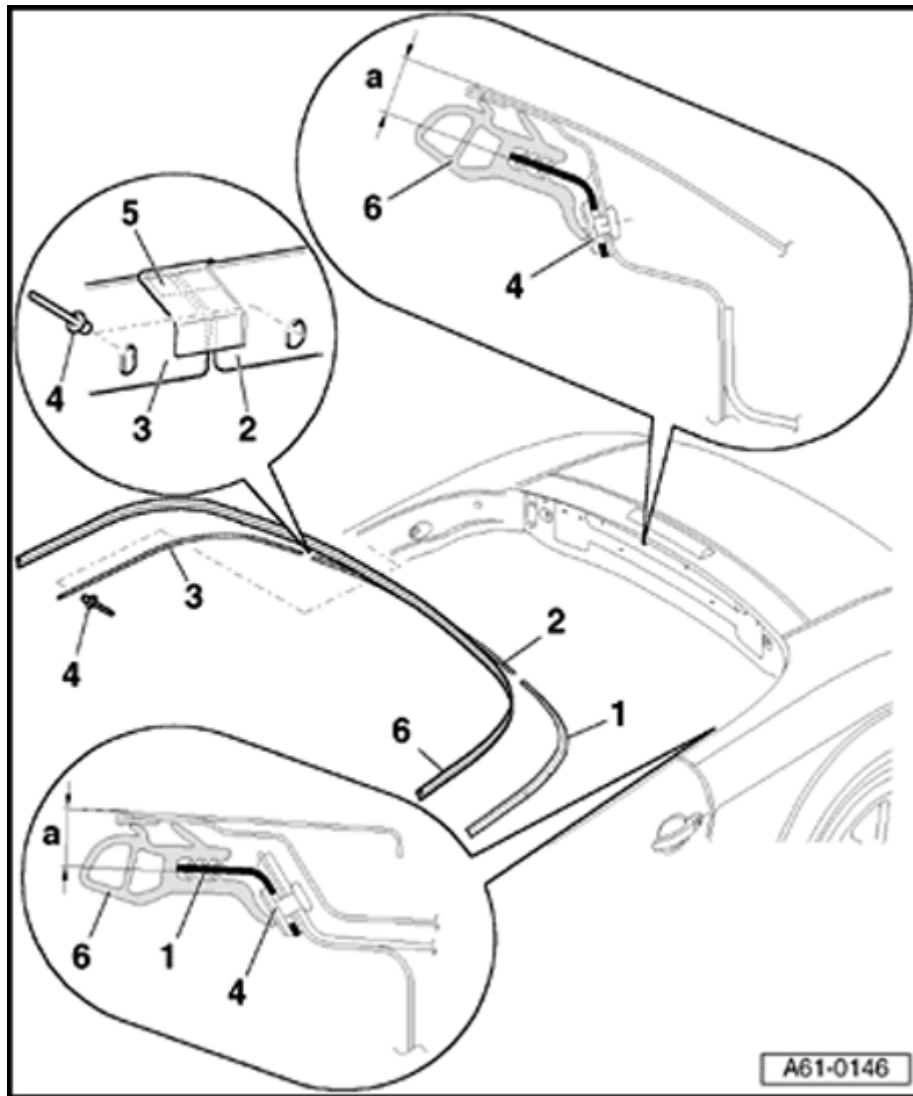

3 - Seal mount, right

4 - Pop rivets (21x)

5 - Adhesive tape

6 - Tensioning strut seal

- ♦ Can be removed or pressed on with convertible top opened half way.